

Santa Cruz Sink

Model # SCS-3219SBA-GMB, SCS-3219SBA-SSB

Specification Sheet

TECHNICAL INFORMATION

- Installation: Undermount or Topmount
- Color: Gun Metal Black (GMB) or Brushed Stainless Steel (SSB)
- Drain Location: Middle Top

PRODUCT FEATURES

- Versatile dual-mount design supports both undermount and drop-in installation, making it compatible with any countertop
- Drain, produce basket, protective stainless steel bottom grid, roll-up multi-purpose rack and acacia cutting board attachments included
- Deep bowl offers superior functionality for busy households
- Made of durable, corrosion-resistant 16-gauge stainless steel, built to withstand heavy and daily use
- Brushed finish for easy cleaning and maintenance
- Mounting template included to assist with installation

NOTES

- Measure your actual product for rough-in details
- Install this product according to the installation instructions
- Due to the natural characteristics of acacia wood, each cutting board will vary in grain, color, and appearance. Images shown are for illustrative purposes only.

WARRANTY

- Lifetime Limited Warranty

DRAIN (SIDE)

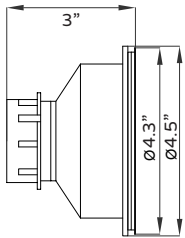

DRAIN (TOP)

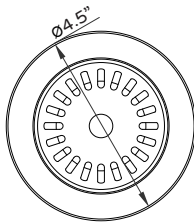

SINK (TOP)

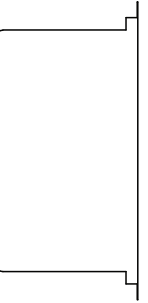
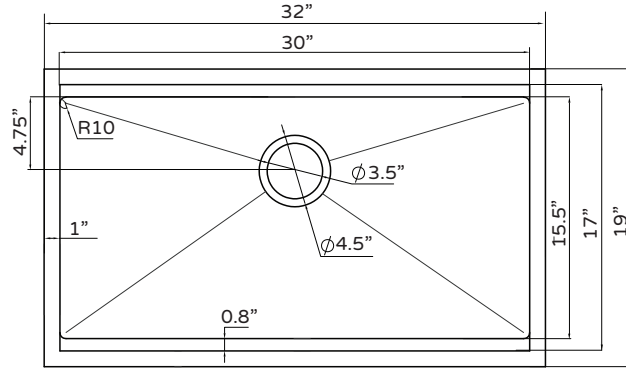

SINK (SIDE)

SINK (FRONT)

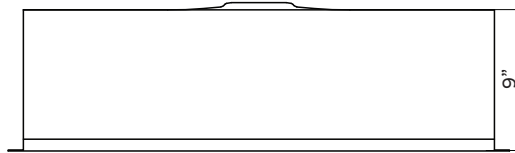

STAINLESS STEEL BOTTOM GRID

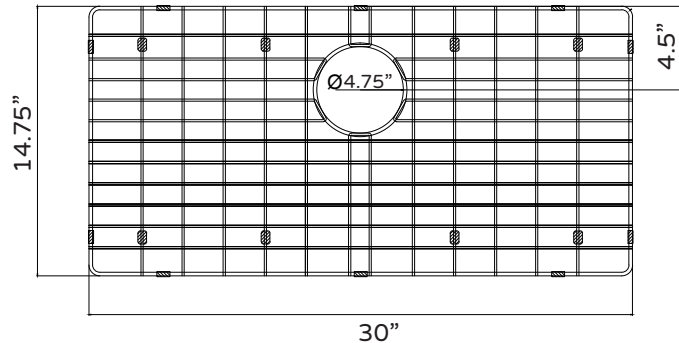

WOODEN CUTTING BOARD (TOP)

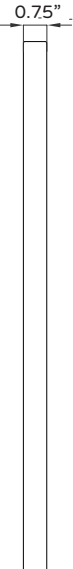
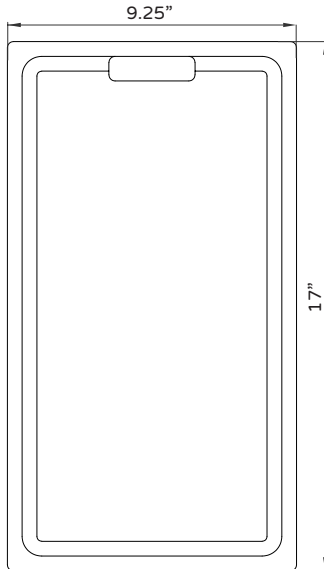

WOODEN CUTTING BOARD (SIDE)

STAINLESS STEEL PRODUCE BASKET

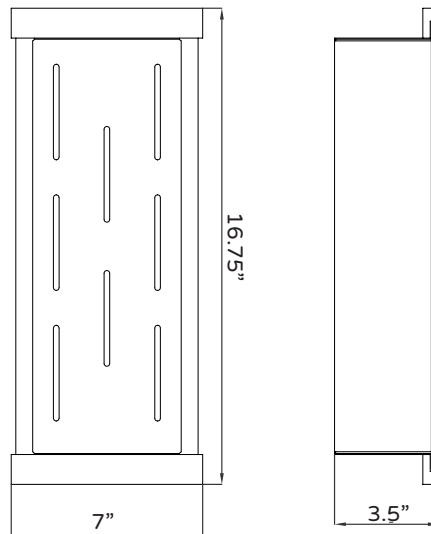

ROLL-UP MULTIPURPOSE RACK

