



Nirvana Shower System

Model #1070-CH

PW-91070-8225CP

Owner's Manual



All images shown are for illustration purposes.
Actual product may vary due to product enhancement.

Please Read The Following Instructions COMPLETELY Before Beginning!

Our goal is to ensure your installation goes smoothly and safely. Please read these instructions carefully and follow recommendations for plumbing and mounting. After reading instructions, if you determine you do not have the necessary skills and/or tools, we recommend that a licensed plumbing contractor complete the installation.

If you encounter any problems during installation
PLEASE VISIT CUSTOMER SUPPORT AT
WWW.PULSESHOWERSPAS.COM
Before returning your shower system to the store

You Will Need The Following Tools

Soft pencil or felt pen to mark tile
Allen wrench
Safety glasses
Phillips screwdriver

Channel locks or adjustable wrench
Plumber's Tape
Drill (Preferably cordless)

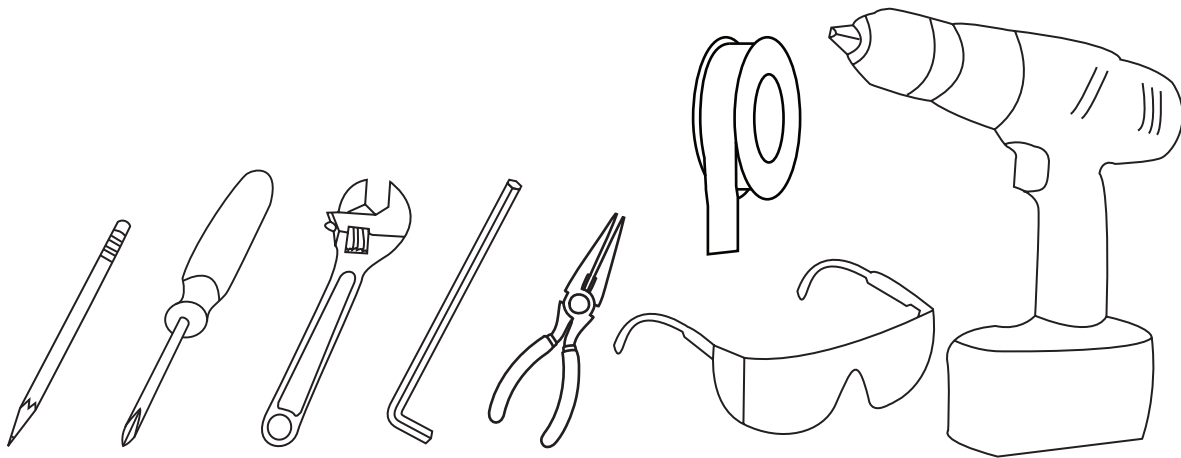

Parts Legend

- | | | |
|----------------------|----------------------------|-------------------------|
| 1. Set Screws | 9. Shelf | 17. Plumber's Tape |
| 2. Shower System | 10. Allen Wrench | 18. Washer |
| 3. Showerhead | 11. Shelf Screw | 19. Loofa Glove |
| 4. Mirror | 12. Wall Mount | 20. Soap Dispenser |
| 5. Handshower | 13. Mounting Screws | 21. Diverter |
| 6. Handshower Holder | 14. Wall Anchors | 22. Soap Control Handle |
| 7. Handshower Hose | 15. Stainless Steel Gasket | |
| 8. Loofa Hose | 16. Glue | |

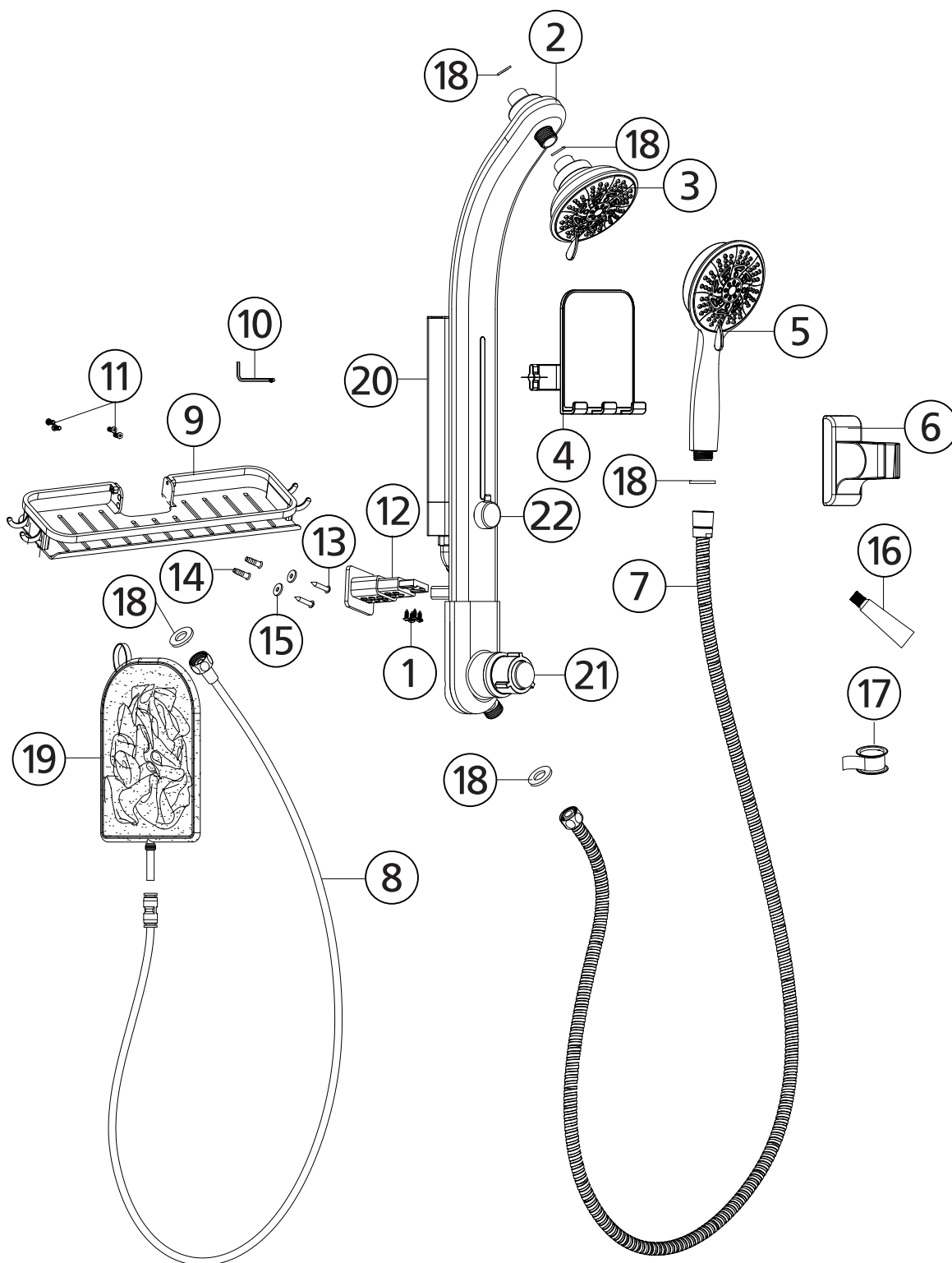

Installation Instructions

BEFORE YOU BEGIN

Measure the following to ensure your shower system will fit properly.

Measure

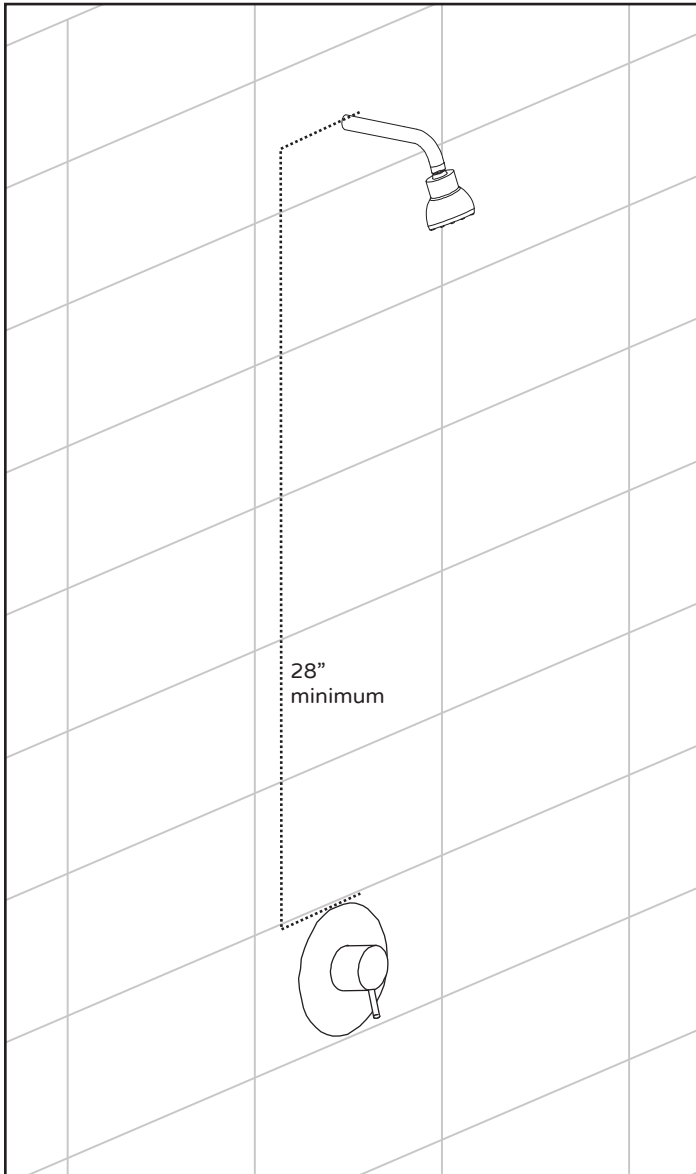

Make sure distance from water outlet and mixing valve trim (NOT INCLUDED) is a minimum 28" or more.

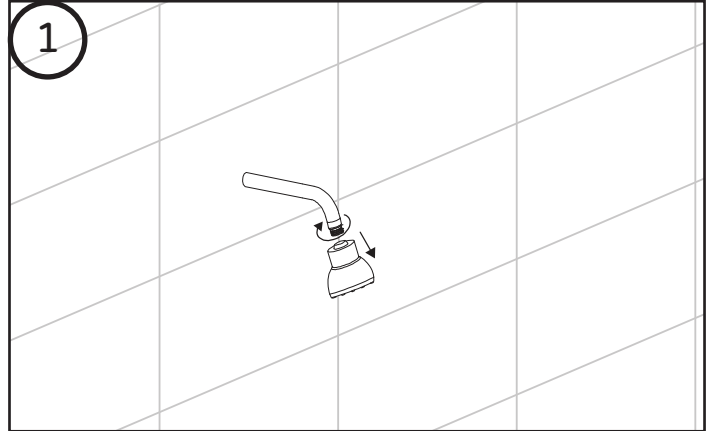

Remove existing showerhead from shower arm

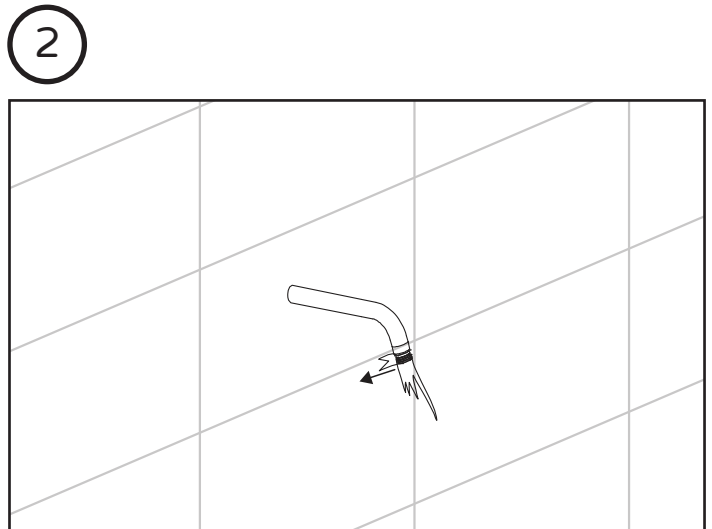

Remove any remnants of old plumber's tape and flush out shower pipe.

Installation Instructions

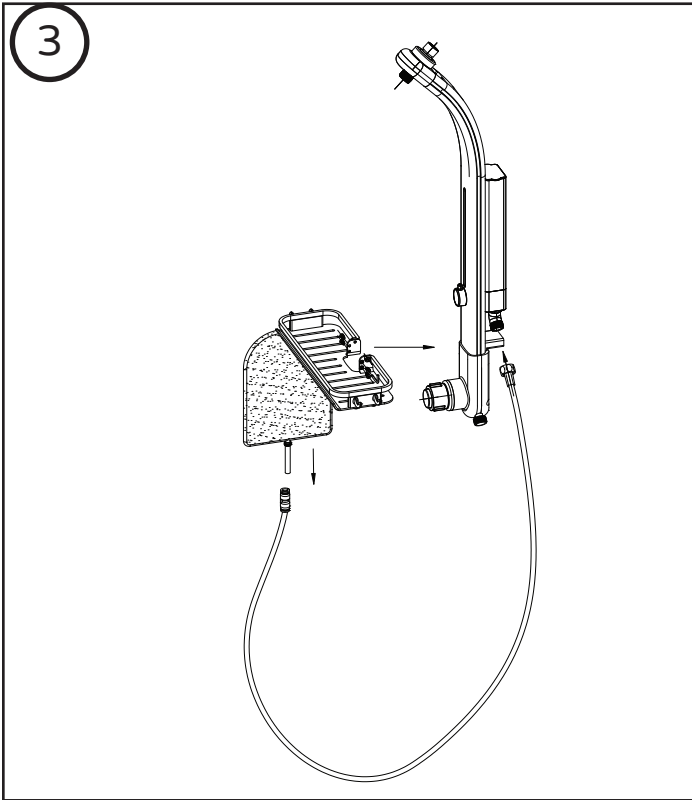

Loofa assembly: Connect loofa (19) and loofa hose (8) to shower system (2).
Shelf assembly: Use allen wrench (10) and shelf screw (11) to assemble the shelf (9) onto the shower system (2).

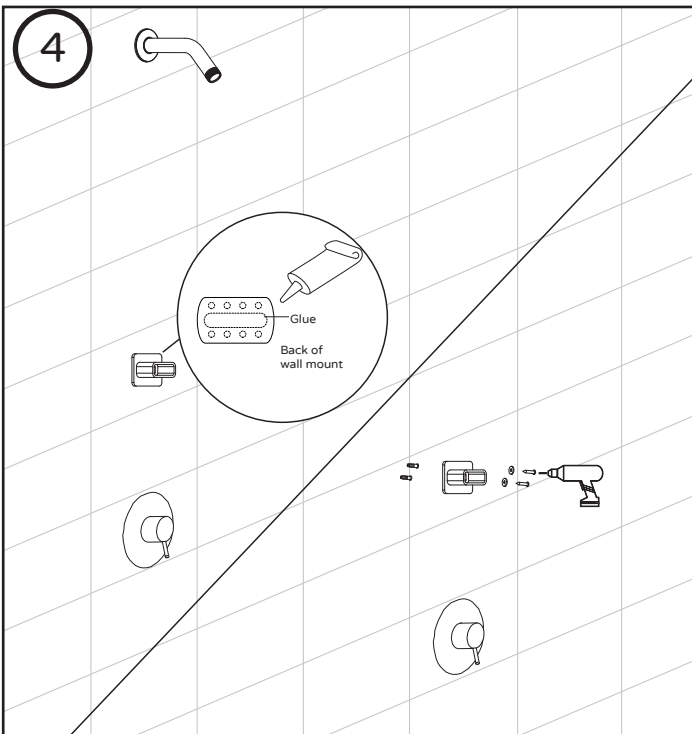

Measure to confirm correct positioning of wall mount (12).
Drill less option: Glue wall mount onto wall, let cure for 24 hours.
Drill Option: Drill wall anchors (14) into place. Drill wall mount (12) using stainless steel gaskets (15) and mounting screws (13).

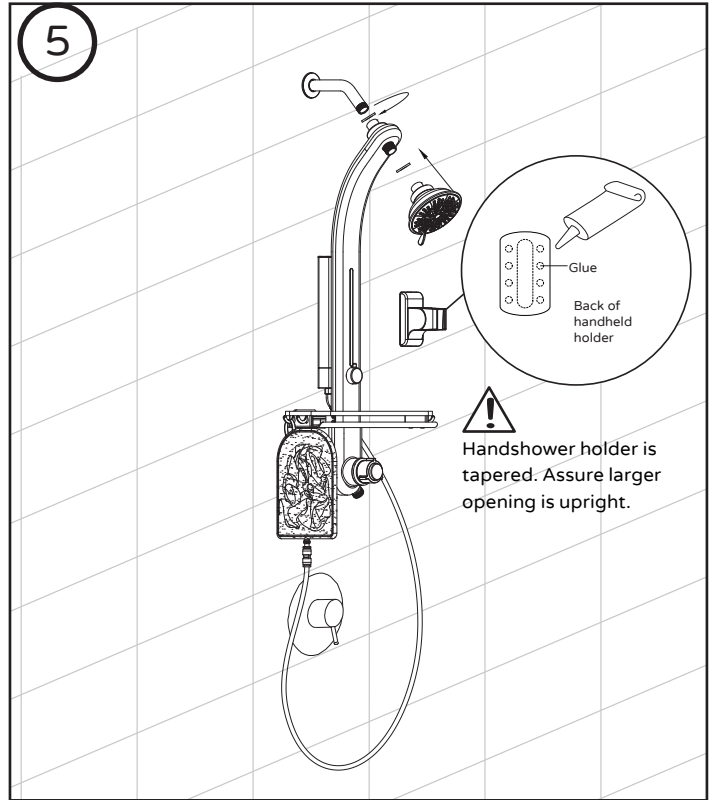

Insert washer (18) and screw shower system (2) onto shower arm.
Insert washer (18) and screw showerhead (3) to shower system (2).
Glue handshower holder (6) onto wall, let cure for 24 hours.

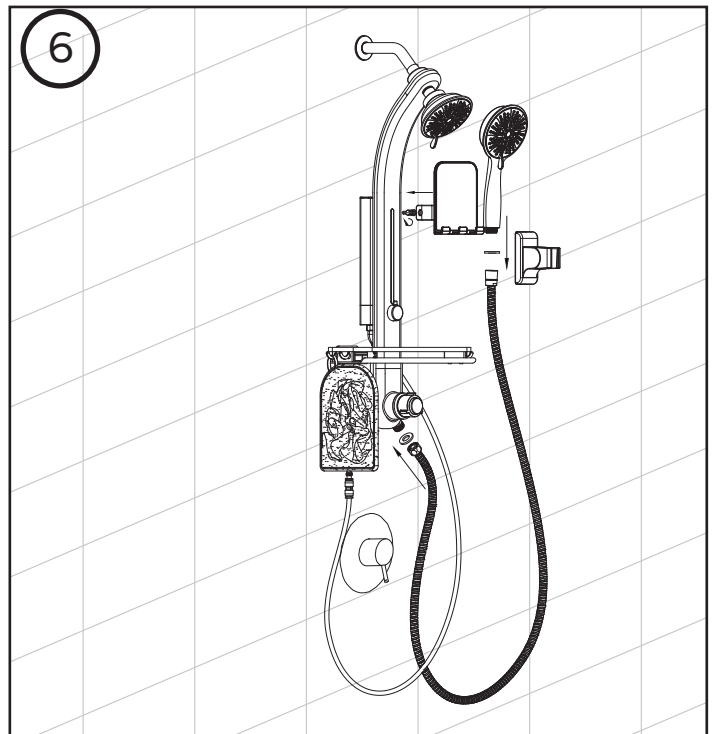

Place mirror (4) onto shower system (2) and secure.
Insert washer (18) into the hex end of the handshower hose (7).
Attach hose to handshower outlet located on the bottom of the diverter (21).
Insert washer (18) into the tapered end of the handshower hose (7) and attach the handshower (5).
Place the tapered end of the hose into the handshower holder (6).

Installation Instructions

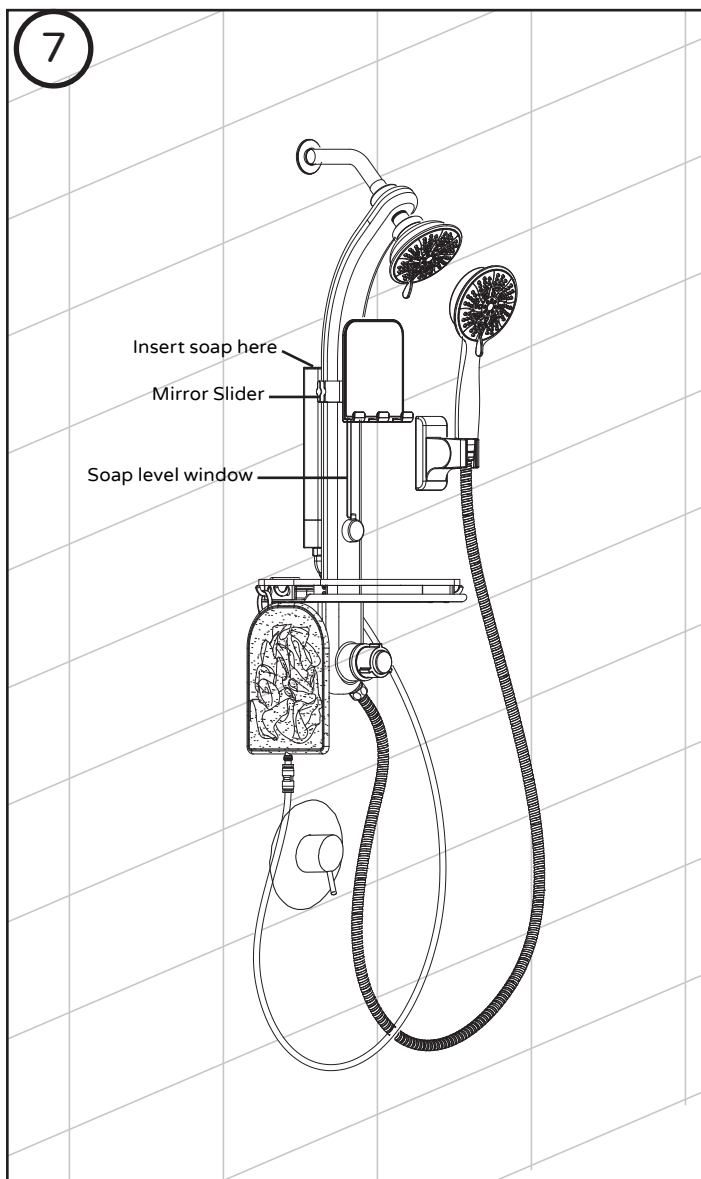

Product fully assembled

USAGE:

Use existing shower valve to turn water on/off and adjust temperature.

Always turn cold water on first to help prevent any accidental burning or scalding; especially for children and elderly.

Use diverter to choose desired function. Switch between showerhead, handshower, or loofa.

Use mirror slider to slide mirror up and down part of the shower system

When using the loofa, make sure you have enough soap in the soap dispenser. Refill soap dispenser at the top.

DO NOT use any part of the shower system as a support device.

SOAP DIVERTER INSTRUCTIONS:

Use soap diverter to control amount of soap on the loofa.

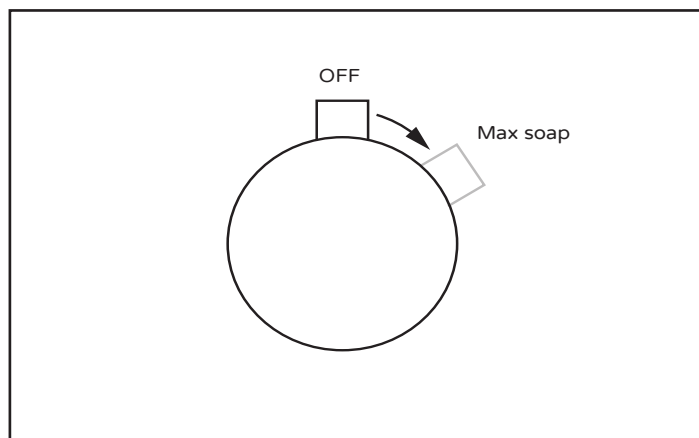

Care and Maintenance

To keep your shower system looking new, wipe down after each use with a soft cotton cloth.

Protect your tub filler from hard water stains and mineral deposits by periodically using an auto spray wax.

Clean using mild liquid soap and a non-abrasive sponge or cloth. Rinse with clean water.

Do Not Use Any Kind Of
Chemicals Or Abrasives!

MANUFACTURER'S LIFETIME LIMITED WARRANTY

1. Defects Covered; Warranty Period: Pulse Shower Spas, Inc. ("Pulse") warrants to the original consumer purchaser who purchases this shower spa (the "Product") for use in his or her own home, that the Product will be free from defects in material and manufacturing workmanship for as long as the original consumer purchaser owns that same home. For all other purchasers (including, but not limited to purchasers for industrial, commercial and business use), the above warranty will apply for a period of 5 years from the original date of purchase.

2. Remedy: If the Product does not conform to the above warranty, Pulse, at its option, will repair or replace the Product, free of charge, or refund your purchase price. For warranty claims, please visit www.pulshowerspas.com/index.php/warranty. Pulse may require that you return the Product to Pulse, shipping prepaid, in which case Pulse will provide you with a return materials authorization number (RMA). Pulse may also require that you provide evidence of the date you purchased the Product. Pulse will ship a new or repaired Product to you, at the expense of Pulse, or refund your purchase price. Service labor performed by you or others in connection with the removal or replacement of the Product will not be reimbursed by Pulse.

3. Exclusions: Pulse shall not be responsible for failure of the Product, and the above warranties will not apply, if the Product fails as a result of improper installation, improper use, modifications or repairs by anyone other than Pulse, or accident or abuse (including damage during shipment).

4. Warranty on Repairs and Replacements: For consumer purchasers who purchased the Product for home use, repaired or replacement Products will continue to be covered under this warranty for as long as he or she owns that same home. For other purchasers, repaired or replacement Products will be covered for the balance of the original warranty period.

5. No Other Warranties; Limitation of Liability: OTHER THAN THE LIFETIME LIMITED WARRANTY STATED ABOVE, PULSE DISCLAIMS ALL OTHER WARRANTIES, EXPRESS OR IMPLIED, INCLUDING BUT NOT LIMITED TO WARRANTIES OF MERCHANTABILITY AND FITNESS FOR A PARTICULAR PURPOSE, TO THE EXTENT PERMITTED BY APPLICABLE LAW. THE REMEDIES STATED ABOVE ARE YOUR SOLE REMEDIES IN CONNECTION WITH THIS WARRANTY. IN NO EVENT WILL PULSE BE LIABLE TO YOU FOR ANY DAMAGES, WHETHER DIRECT, INDIRECT, INCIDENTAL, SPECIAL OR CONSEQUENTIAL, INCLUDING BUT NOT LIMITED TO LOST PROFITS OR BUSINESS INTERRUPTION, ARISING OUT OF OR RELATING TO THE PRODUCT OR ITS USE, WHETHER UNDER A CONTRACT, WARRANTY, TORT, OR ANY OTHER CAUSE OF ACTION, EVEN IF PULSE HAS BEEN ADVISED OF THE POSSIBILITY OF SUCH DAMAGES. NOTWITHSTANDING THE TERM OF ANY LIMITED OR IMPLIED WARRANTY, OR IN THE EVENT THAT ANY LIMITED WARRANTY FAILS OF ITS ESSENTIAL PURPOSE, IN NO EVENT WILL PULSE'S ENTIRE LIABILITY EXCEED THE PURCHASE PRICE OF THE PRODUCT. SOME STATES AND PROVINCES DO NOT ALLOW THE EXCLUSION OR LIMITATION OF INCIDENTAL OR CONSEQUENTIAL DAMAGES SO THE ABOVE LIMITATIONS OR EXCLUSIONS MAY NOT APPLY TO YOU. THIS LIMITED WARRANTY GIVES YOU SPECIFIC LEGAL RIGHTS, AND YOU MAY ALSO HAVE OTHER RIGHTS WHICH VARY FROM STATE TO STATE AND PROVINCE TO PROVINCE.

NOTES

