

GENERAL DESCRIPTION

Simple yet sophisticated, the Hanalei ShowerSpa is astonishing! A stunning, pure white Tough Glass panel and polished chrome fixtures combine elegant beauty with outstanding features.

Choose between invigorating body jets, a low profile 9" rain showerhead, brass hand shower or tub spout to find the perfect balance of cleanliness and relaxation. With sleek styling, powerful spray functions and a thermostatic mixing valve, the Hanalei is a vessel of soothing hydrotherapy.

PRODUCT FEATURES

- Surface mounted and completely pre-plumbed, easily retrofit your existing shower without a remodel
- Pure white tempered 8mm Tough Glass panel on a sturdy anodized aluminum frame
- Polished chrome fixtures beautifully accent the pure white glass panel with infinity edge
- 9" Low profile rain showerhead with soft tips to prevent mineral buildup for long lasting performance
- 3 Stimulating brass body jets provide a soothing alternative to the showerhead or hand shower
- Invigorating hand shower with double-interlocking stainless steel hose, stretches from 59–78" (1.5–2m)
- Thermostatic valve allows you to leave the ShowerSpa set to your desired temperature
- Rub tips clean with Spray Straight™ technology
- Brass diverter easily switches functions—place between functions for further enjoyment
- Brass tub spout/temperature tester
- cUPC approved complete shower system

SPECIFICATIONS

- cUPC® approved thermostatic mixing valve provides safety and convenient temperature control
- ½" NPT flexible stainless steel braided supply lines
- 2.5 GPM/9.5 LPM Shower System

WARRANTY

- Manufacturer's three year limited warranty

INVIGORATE...

DECORATE...

REJUVENATE...

Create harmony and balance via hydrotherapy!
Add style, convenience & function to your shower!
There's no better way to start your day!

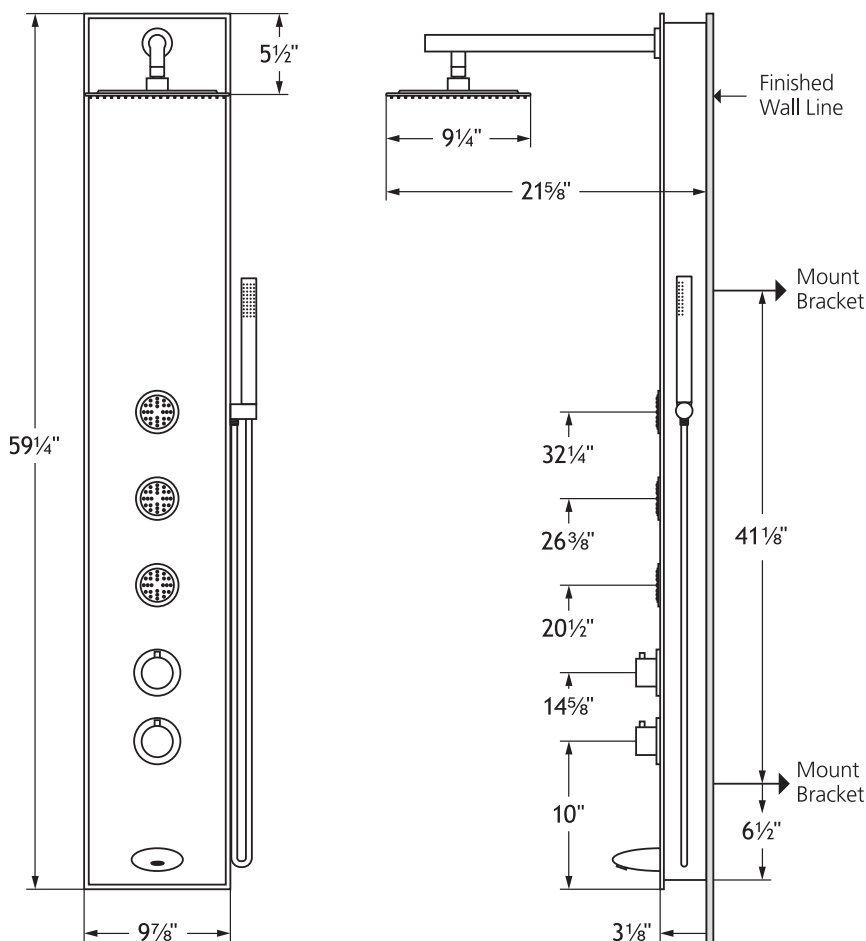
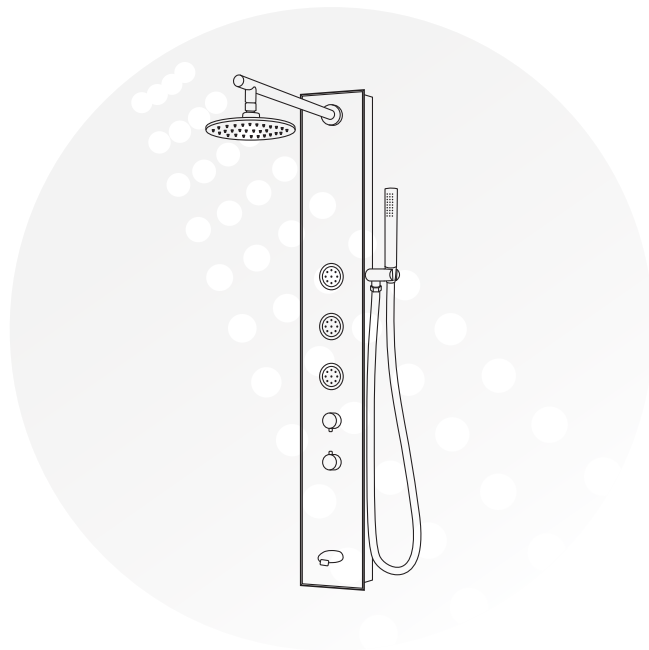

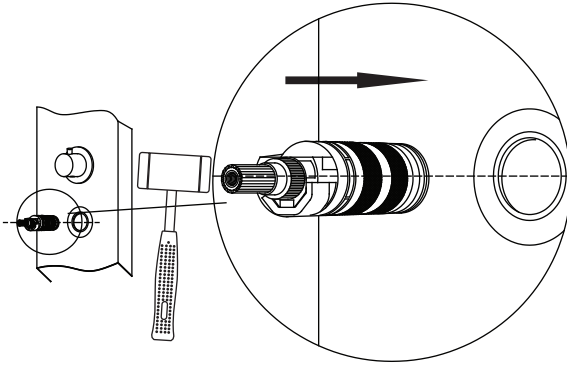

- ① Place valve in place with a rubber hammer (ensure the screw head pointing to the cut off of the plated ring)

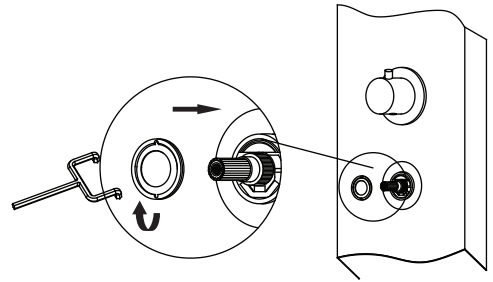

- ② Put golden ring on top of valve

Red color in a straight line

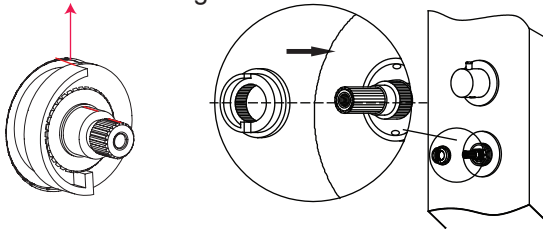

- ③ Put plastic ring in place

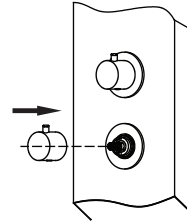

- ④ Press the button on the head and put on the head as below ensuring the screw hole pointing to the front

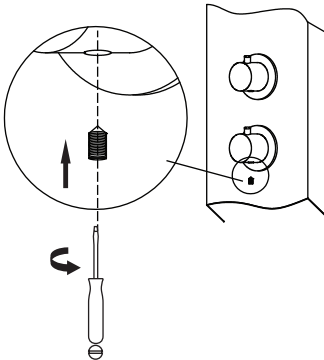

- ⑤ Use tool to fix the screw tightly

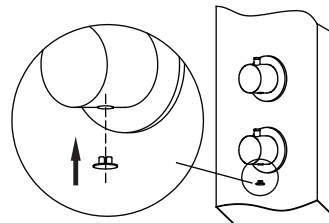

- ⑥ Put on cap

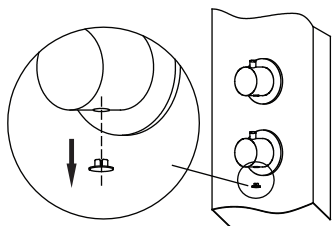

① Take off cop

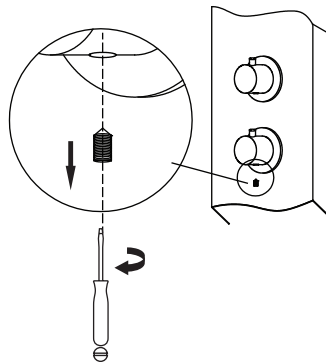

② Loosen screw off with tool

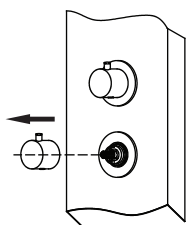

③ Take off head

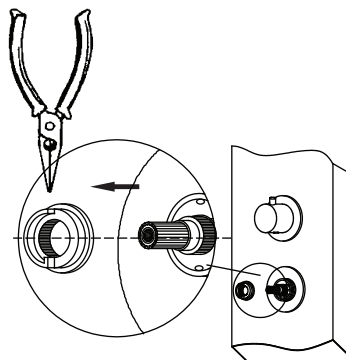

④ Take off plastic ring

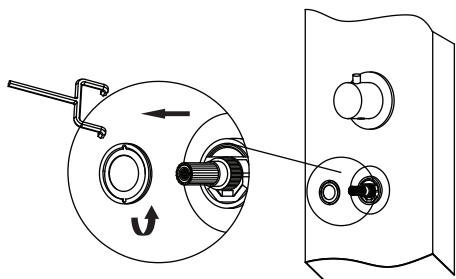

⑤ Position the tool to the two points on the golden ring and pull out the valve

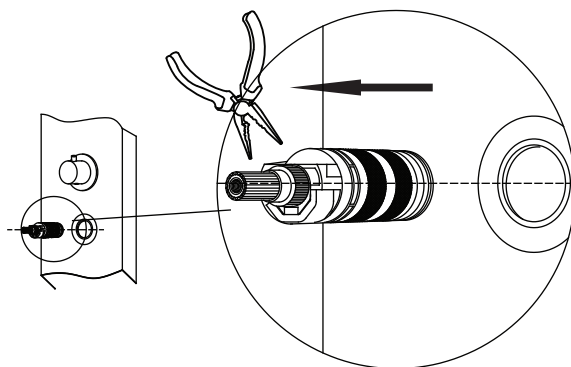

⑥ Remove the valve