



Manufacturer's Warranty

PULSE Showerspases, Inc. warrants that all Showerspases are free from defect in workmanship and/or materials for a period of three years from the date of purchase. This warranty extends to the original purchaser only and is non-transferable.

This warranty does not cover, and PULSE Showerspases will not pay for conditions, malfunctions or damages resulting from (1) normal wear and tear, improper installation, whether performed by a contractor, service company or the consumer, improper maintenance, misuse, abuse, negligence, accident or alteration; (2) the use of abrasive and/or caustic cleaning agents or "no-rinse" cleaning products or the use of the product in any manner contrary to the product instruction; or (3) conditions in the home such as excessive water pressure or corrosion.

Should any Showerspa be determined by PULSE Showerspases, Inc. to be defective in normal residential use, at the option of PULSE Showerspases, Inc., such product shall either be replaced or repaired and returned to the customer free of defects. The consumer shall give notice of any defects to PULSE Showerspases, Inc. within thirty days of discovery of such defect.

Proof of purchase (original sales receipt) must be provided to PULSE Showerspases, Inc. with all warranty claims. PULSE Showerspases, Inc. is not responsible for labor charges, removal charges, installation or other consequential costs. In no event shall the liability of PULSE Showerspases, Inc. exceed the purchase price of the Showerspases.

Some states/provinces do not allow limitations of how long an implied warranty lasts or the exclusion or limitation of such damages, so these limitations and exclusions may not apply to you. This warranty gives the consumer specific legal rights. You may also have other rights that vary from state/province to state/province.

Follow manufacturers recommended installation. Use caution with children under ten years of age. Do not use Showerspa as a support device. Do not use harsh chemicals or abrasives when cleaning. Turn water supply off when servicing Showerspases.



Kauai II Rain Shower System Installation Instructions Model #1011

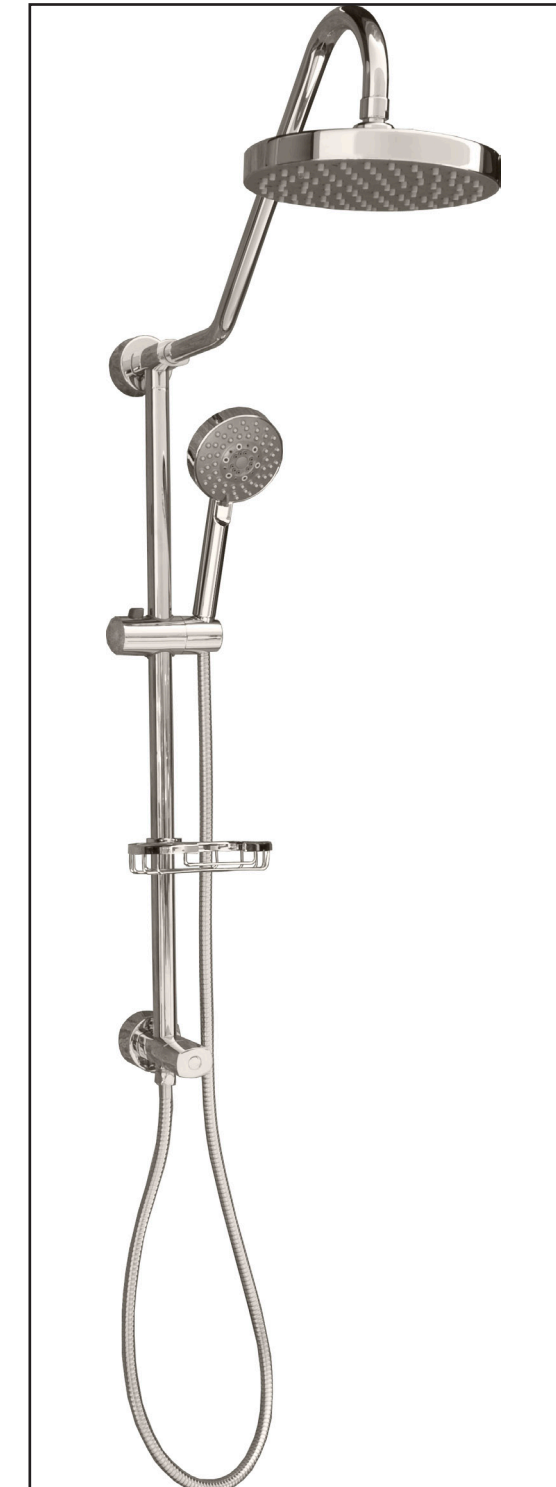

Kauai II Rain Shower System

Numbered Components

Thank you for choosing the #1011 Kauai II Rain Shower System by PULSE Showerspapas!

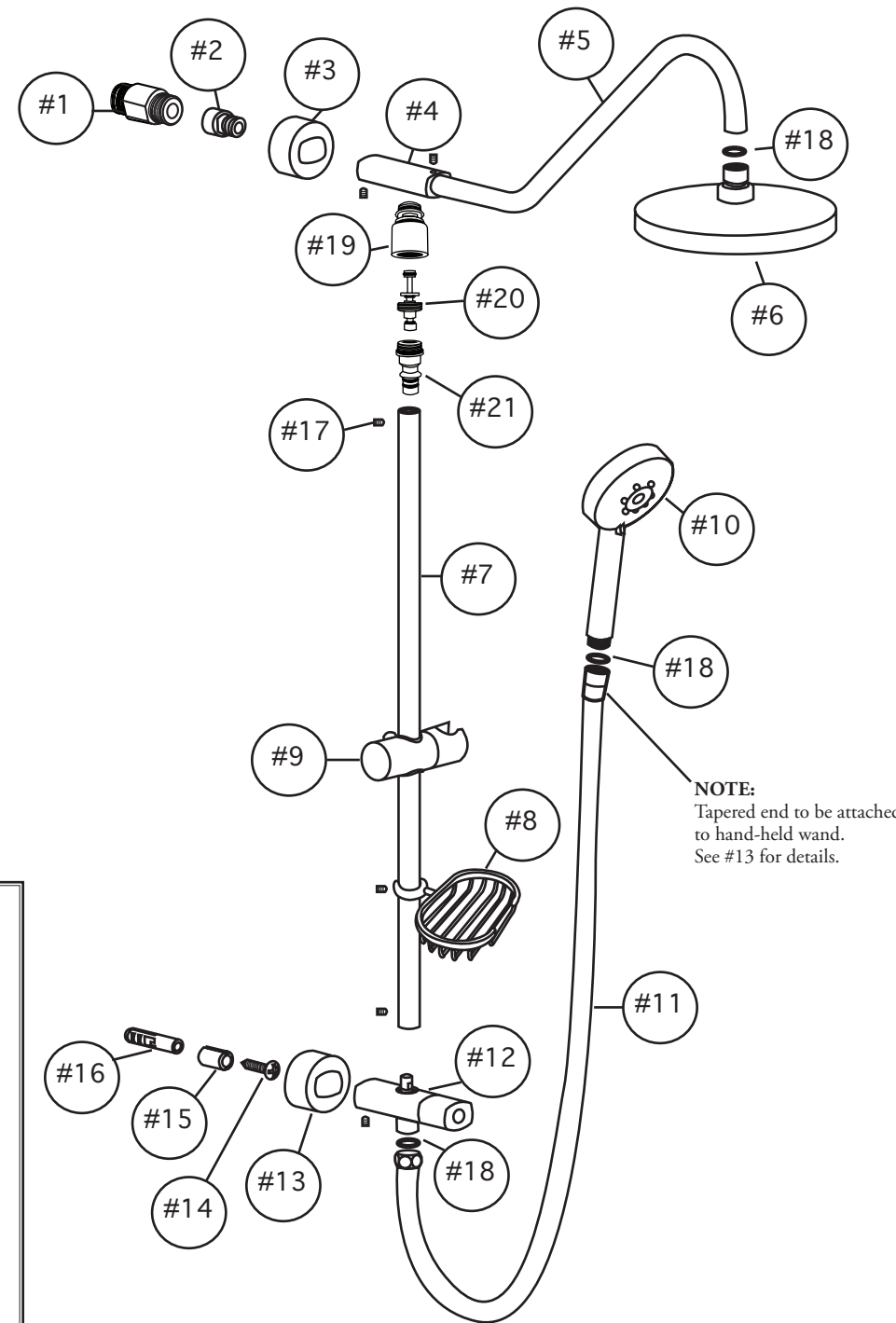
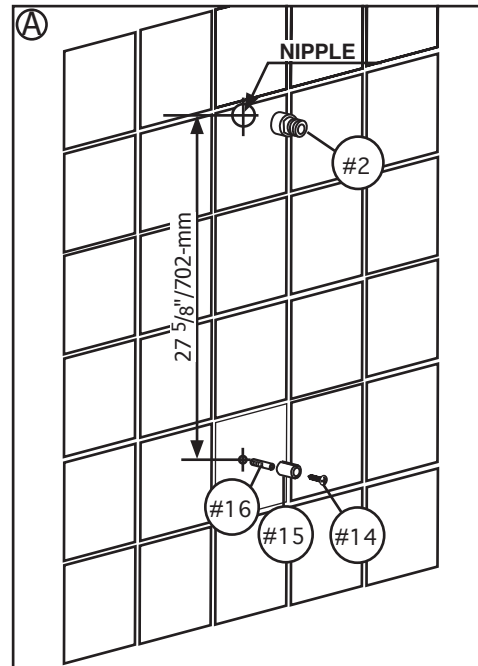

PARTS LEGEND

- #1. 1/2" x 2" NPT Nipple
- #2. Inlet Fitting
- #3. Top Escutcheon
- #4. Top Tee
- #5. Shower Arm
- #6. Shower Head
- #7. Shower Pipe*
- #8. Soap Dish
- #9. Adjustable Hand Held Hanger
- #10. Handheld Shower
- #11. Stainless Steel Hose
- #12. Bottom Tee/Diverter
- #13. Bottom Escutcheon
- #14. Lower Mount Screw
- #15. Lower Mount
- #16. Wall Anchor
- #17. Set Screw (in place, qty 6)
- #18. Rubber Washer (qty 3)
- #19. Actuator Housing
- #20. Actuator
- #21. Top Brass Fitting**

*NOTE: 4 inch shorter shower pipe (#7) available by special order

**NOTE: Top Brass Fitting can be removed with allen wrench

The assembly and installation of the Kauai II Rain Shower System is designed to be quick and easy. If you have any installation questions or performance problems, call PULSE Customer Service toll free at 888-785-7320 or visit www.pulshowerspas.com for more information.

Please read instructions carefully, become familiar with all parts (Figure A), installation procedures and tools required. Follow the steps in the order presented to help avoid any mistakes.

Tools required: Drill (preferably cordless), 6mm (1/4") masonry/tile drill bit, adjustable wrench, Philips screw driver,

1. Determine the length nipple needed.
 - a. Place mark on existing shower arm at wall surface.
 - b. Unscrew shower arm from elbow in wall.
 - c. Measure distance from mark on shower arm to end of shower arm threads.
 - d. Add 1/2 inch to this measurement, and then round up to nearest 1/2 inch. (i.e. If measurement = 1 3/4 inches, add 1/2 inch = 2 1/4 inches rounded up = 2 1/2 inch NPT nipple. This is the minimum length required with maximum length to be + 1 inch. **NOTE:** For new construction or extensive remodel nipple should extend 1/2" past finished wall surface.

IMPORTANT: If shower arm is located in wall above tile/fiberglass wall surface you must add the distance from the sheetrock to face of the tile/fiberglass shower wall to the above measurement.

NOTE: If supplied 2 inch nipple (1) is not the correct length based on above formula, you must obtain the correct size - sold separately. Various length NPT brass nipples are readily available at most hardware stores.

2. Apply generous amount of Teflon tape and/or pipe sealant to both ends of the nipple (1).
3. Screw inlet fitting (2) onto nipple (1) and tighten nipple into elbow in wall using an adjustable wrench on flat sides of the inlet fitting. Tighten securely to ensure no leaks.
4. To locate lower mount (15) measure down 702mm (27 5/8 in.) from the center of the inlet fitting (2) and make a mark on the wall. Make sure mark is inline (plumb) with center of inlet fitting. Use 6mm(1/4inch) masonry bit to carefully drill 35mm(1 3/8 inch) depth hole. **CAUTION:** Live plumbing behind wall. (reference diagram A.)
5. Insert wall anchor (16) in hole and attach lower mount (15) with screw (14)
6. Determine top & bottom of shower pipe (7) – larger diameter opening is top of shower pipe.
7. Slide soap dish (8) onto bottom of shower pipe (7) and secure with set screw (17). **CAUTION:** Do not over-tighten.
8. Insert top tee (4) with shower arm (5) attached into top of shower pipe (7). Secure with set screw (17).
9. Insert bottom tee/diverter (12) into bottom of shower pipe (7) and secure with set screw (17).
10. Slide top escutcheon (3) over top tee (4).
11. Slide bottom escutcheon (13) over bottom tee/diverter (12).
12. Push top tee (4) over the inlet fitting (2) until flush against fitting while aligning bottom tee/diverter (12) over lower mount (15). Secure both top tee and bottom tee with Allen set screws. **NOTE:** Make shower pipe parallel to wall by adjusting at bottom mount
13. Insert rubber washer (18) into both ends of hose (11). Connect hex head end to outlet on bottom tee (12) and tapered end to handheld shower (10). Place handheld shower (10) into adjustable hanger (9).
14. Insert rubber washer (18) in shower head (6) and tighten securely to shower arm (5).

USAGE:

Diverter valve controls the shower head and handheld shower function. Turn diverter counterclockwise for handheld shower, clockwise for shower head.

Adjust the hand held position by depressing the button on the hanger and slide it up or down.

When showering, turn cold water on first to help prevent any burning/scalding accident; especially for children and elderly.

Do not use any part of the Kauai II Rain Shower System as a support device.

CARE:

Keep the product looking new by wiping off with soft cotton cloth after each use. Use only mild liquid soap and rinse with clean water. Do not use any kind of chemicals or abrasives.