

KAUAI II



PULSE

SHOWERS PAS

Kauai II Rain Shower System

Installation Instructions

Model 1011-CH, 1011-BN & 1011-ORB



Kauai II Numbered Components

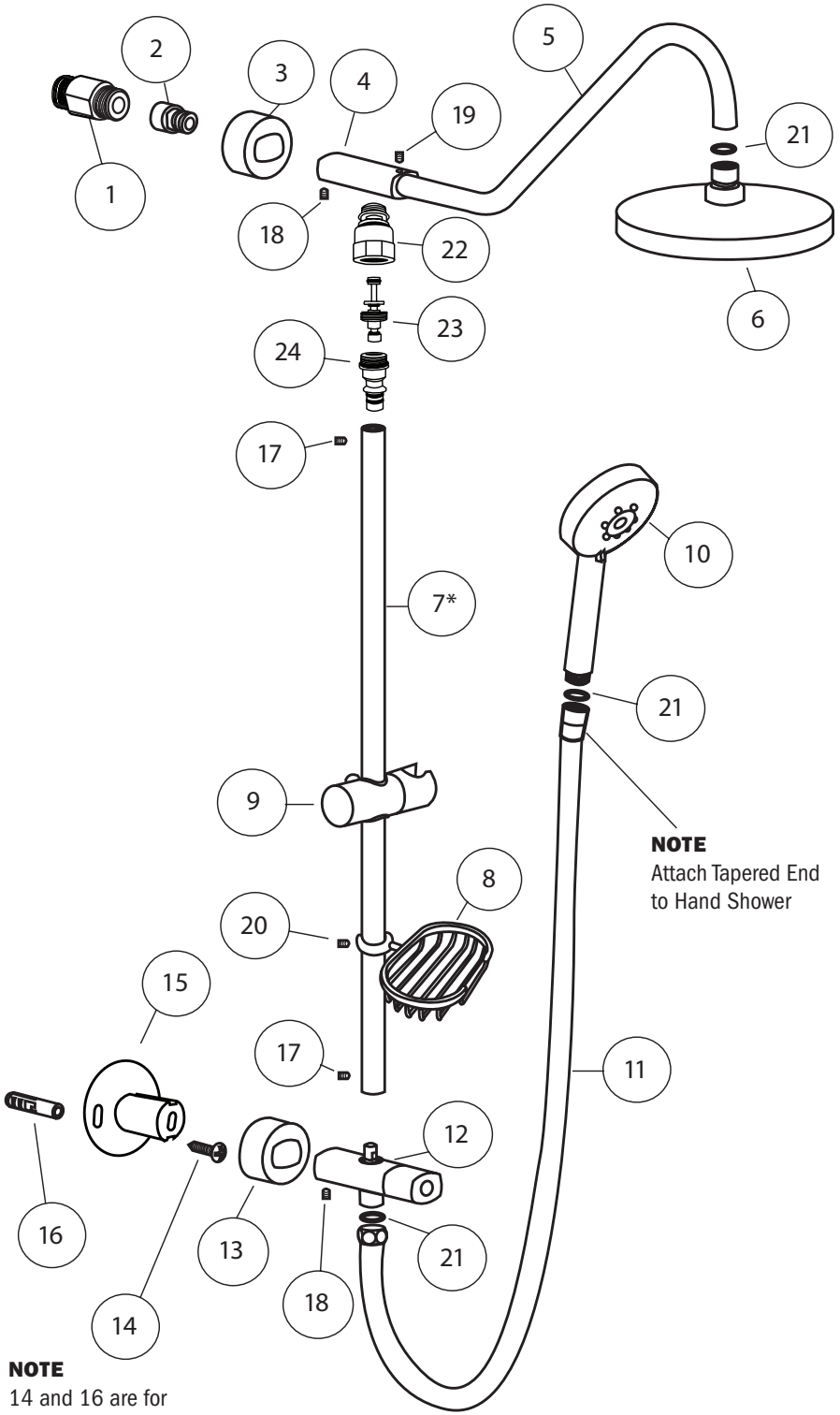
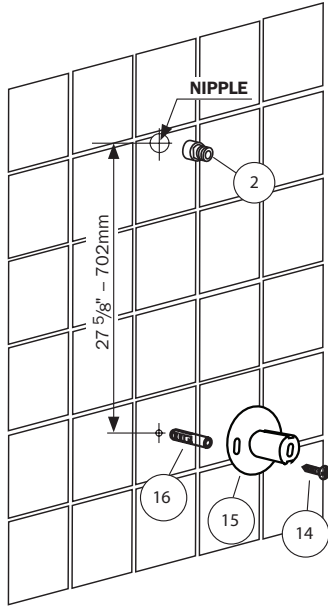

Kauai II Parts Legend

- 1. ½" x 2" NPT Nippleqty 1
- 2. Inlet Fitting.....qty 1
- 3. Top Escutcheon.....qty 1
- 4. Top Tee.....qty 1
- 5. Shower Arm.....qty 1
- 6. Shower Headqty 1
- 7. Shower Pipe.....qty 1*
- 8. Soap Dish.....qty 1
- 9. Hand Shower Hanger.....qty 1
- 10. Hand Showerqty 1
- 11. Stainless Steel Hoseqty 1
- 12. Diverter.....qty 1
- 13. Bottom Escutcheon.....qty 1
- 14. Lower Mount Screwqty 2
- 15. Lower Mount w/ 2-Faced Tape...qty 1
- 16. Wall Anchor.....qty 2
- 17. Set Screw (in place).....qty 2
- 18. Set Screw (in place).....qty 2
- 19. Set Screw (in place).....qty 1
- 20. Set Screw (in place).....qty 1
- 21. Rubber Washerqty 3
- 22. Actuator Housingqty 1
- 23. Actuator.....qty 1
- 24. Top Brass Fittingqty 1**

NOTE
Attach Tapered End
to Hand Shower

NOTE
14 and 16 are for
Optional Mounting

***NOTE**—4" shorter shower pipe (7*) available by special order

****NOTE**—Top Brass Fitting can be removed with allen wrench

Kauai II Installation Instructions

Thank you for choosing the #1011 Kauai II Rain Shower System by PULSE ShowerSpas!

The assembly and installation of the Kauai II Rain Shower System is designed to be quick and easy. If you have any installation questions or performance problems, call PULSE Customer Service toll free at 888-785-7320 or visit www.pulshower spas.com for more information.

Please read instructions carefully, become familiar with all parts, installation procedures and tools required. Follow the steps in the order presented to help avoid any mistakes.

FOR NEW CONSTRUCTION OR COMPLETE REMODEL

- A hot/cold mixing valve is required (NOT INCLUDED)
- Nipple should extend $\frac{1}{2}$ " past finished wall surface.

Tools required:

Adjustable wrench, Phillips screw driver, Pencil

1. Determine the length nipple needed.
 - a. Place mark on existing shower arm at wall surface.
 - b. Unscrew shower arm from elbow in wall.
 - c. Measure distance from mark on shower arm to end of shower arm threads.
 - d. Add $\frac{1}{2}$ " to this measurement, and then round up to nearest $\frac{1}{2}$ ". (i.e. If measurement = $1\frac{3}{4}$ ", add $\frac{1}{2}$ " = $2\frac{1}{4}$ " rounded up = $2\frac{1}{2}$ " NPT nipple.) This is the minimum length required.
 - e. Maximum length of nipple is $3\frac{1}{2}$ ".

IMPORTANT—If shower arm is located in wall above tile/fiberglass wall surface you must add the distance from the sheetrock to face of the tile/fiberglass shower wall to the above measurement.

NOTE—If supplied 2" nipple (1) is not the correct length based on above formula, you must obtain the correct size—sold separately. Various length NPT brass nipples are readily available at most hardware stores.

2. Apply generous amount of EITHER Teflon tape OR pipe sealant to both ends of the nipple (1).
3. Screw inlet fitting (2) onto nipple (1). Tighten nipple into elbow in wall using adjustable wrench on flat sides of the inlet fitting. Tighten securely to ensure no leaks.

4. Slide hand shower hanger (9) off shower pipe (7). Slide soap dish (8) onto shower pipe (7) to desired position and secure with set screw (20).

CAUTION — DO NOT OVER-TIGHTEN

5. Reinstall hand shower hanger (9).
6. Insert top tee (4) with shower arm (5) into top of shower pipe (7). Secure with set screw (17).
7. Slide top escutcheon (3) over top tee (4).
8. Slide bottom escutcheon (13) over diverter (12).
9. Loosen set screw (18) on diverter and slide lower mount (15) into diverter (12).
10. Push top tee (4) over inlet fitting (2) until flush against fitting while positioning diverter (12) so shower pipe is vertical. Mark location of lower mount.
11. Wall surface must be clean of any residue and completely dry. Remove covering of two face tape and reposition lower mount to mark. Apply pressure to mount for 30 seconds by pushing firmly against the diverter. To ensure proper adhesion, keep area around the mount dry for first 24 hours.

OPTIONAL—Secure lower mount with permanent wall anchors – mark hole locations in lower mount (15). Drill $1\frac{1}{4}$ " deep holes using 6mm ($\frac{1}{4}$ ") masonry/tile drill bit. Insert wall anchors (16) and secure lower mount with screws (14)

CAUTION — LIVE PLUMBING IN WALL

NOTE—Make shower pipe parallel to wall by adjusting diverter on lower mount. Secure diverter to lower mount with Allen set screw (18).

12. Insert rubber washer (21) into both ends of hose (11). Connect hex head end to outlet on diverter (12) and tapered end to handheld shower (10). Place handheld shower (10) into adjustable hanger (9).
13. Insert rubber washer (21) in shower head (6) and tighten securely to shower arm (5).



PULSE

SHOWER SPAS

Using Your ShowerSpa

Diverter valve controls the shower head and hand shower function. Turn diverter counterclockwise for hand shower, clockwise for shower head.

Turn face of hand shower to switch settings.

Adjust the hand shower position by depressing the button on the hanger and sliding up or down.

Always turn cold water on first to help prevent any accidental burning or scalding; especially for children and elderly.

Silicone tips provide “Rub Clean” technology. When in operation rub the tips to break up any mineral deposits ensuring “Spray-Straight” performance.

Do not use any part of the Kauai II Rain Shower System as a support device.

Care and Maintenance

To keep your ShowerSpa looking new, wipe down after each use with a soft cotton cloth.

Protect your ShowerSpa from hard water stains and mineral deposits by periodically using an auto spray wax.

Clean using mild liquid soap and a non-abrasive sponge or cloth. Rinse with clean water.

Do not use any kind of chemicals or abrasives.

If the flow rate of your ShowerSpa is less than expected, reduces over time or functions are not completely independent, the actuator can be removed to clean sediment. Please CALL TECH SUPPORT @ 1-888-785-7320 and we will be happy to assist you.

Manufacturer's Limited Warranty

PULSE Shower Spas, Inc. warrants that all ShowerSpas are free from defect in workmanship and/or materials for a period of three years from the date of purchase. This warranty extends to the original purchaser only and is non-transferable.

This warranty does not cover, and PULSE ShowerSpas will not pay for conditions, malfunctions or damages resulting from (1) normal wear and tear, improper installation (whether performed by a contractor, service company or the consumer), improper maintenance, misuse, abuse, negligence, accident or alteration; (2) the use of abrasive, caustic or “no-rinse” cleaning agents; (3) the use of the product in any manner contrary to the product instruction; (4) conditions in the home such as excessive water pressure or corrosion.

Should any ShowerSpa be determined by PULSE ShowerSpas, Inc. to be defective in normal residential use, at the option of PULSE ShowerSpas, Inc., such product shall either be replaced or repaired and returned to the customer free of defects. The consumer shall give notice of any defects to PULSE ShowerSpas, Inc. within thirty days of discovery of such defect.

Proof of purchase (original sales receipt) must be provided to PULSE Shower Spas, Inc. with all warranty claims. PULSE ShowerSpas, Inc. is not responsible for labor charges, removal charges, installation or other consequential costs. In no event shall the liability of PULSE ShowerSpas, Inc. exceed the purchase price of the ShowerSpa.

Some states/provinces do not allow limitations of how long an implied warranty lasts or the exclusion or limitation of such damages, so these limitations and exclusions may not apply to you. This warranty gives the consumer specific legal rights. You may also have other rights that vary from state/province to state/province.

Follow manufacturers recommended installation. Use caution with children under ten years of age. Do not use your ShowerSpa as a support device. Do not use harsh chemicals or abrasives when cleaning. Always turn water supply off when servicing your ShowerSpa.